

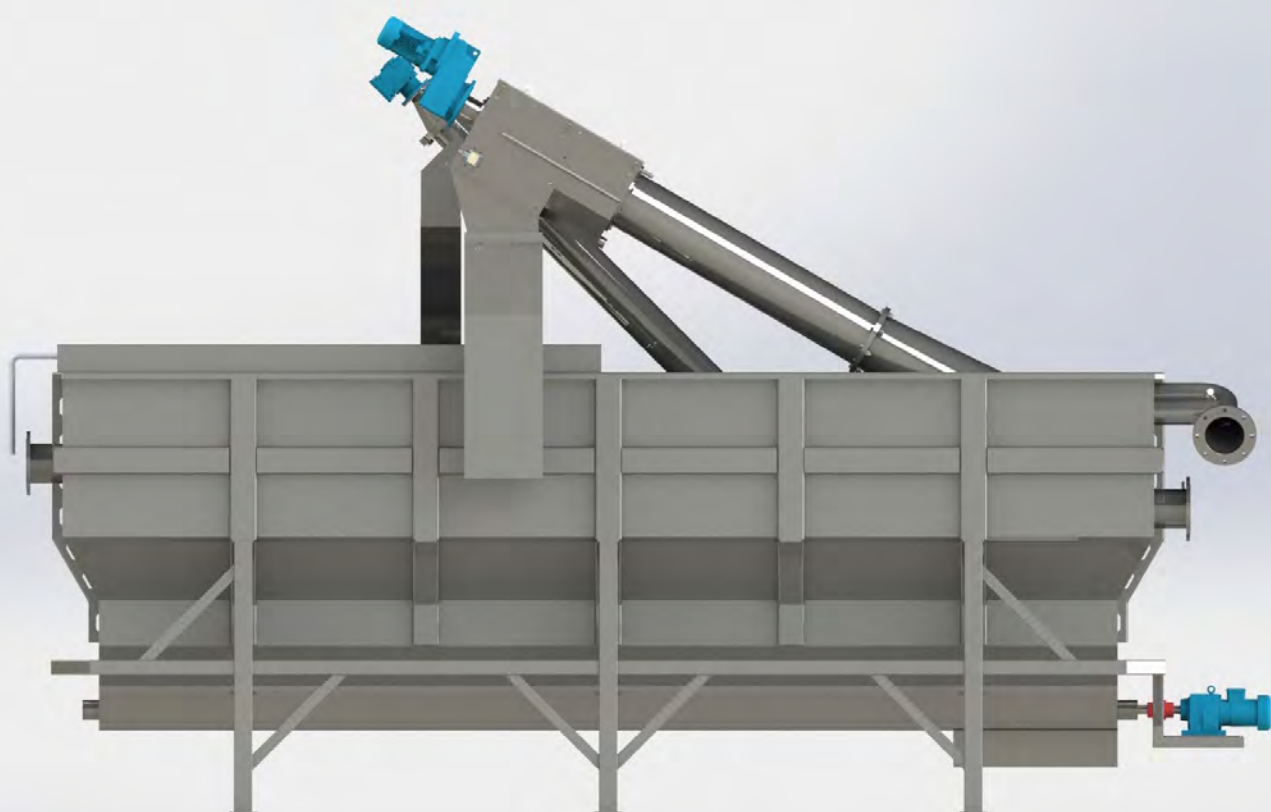

## **PACKAGE TYPE SCREENING GRIT REMOVING AND OIL SEPARATOR PRE TREATMENT UNIT**



[www.baharmuhendislik.com](http://www.baharmuhendislik.com)



# PACKAGE TYPE SCREENING, GRIT REMOVING AND OIL SEPARATOR PRE TREATMENT UNIT

## ***General Description and Intended Use***

It is equipment used to remove the solid materials, oil-grease and grit received with the wastewater in the wastewater treatment plant from the wastewater. Package pre-treatment units are preferred because they perform many pre-treatment processes together and they do not need reinforced concrete structures such as classic grit / oil removal pools.

## ***Working Principle Of Equipment***

In the first container where the wastewater enters in the plant, the solid materials are captured and carried by the inlet screen and removed. The wastewater screened in this container pass through the package tank. The air given into the tank via tube diffusers allows floating of the oil on the water surface and taking to oil channel. The surface scraper in the oil channel collects the dirt, oil, etc. pollutants on the surface of the wastewater and directs them to the scraping ramp. When the wastes collected by the surface scraper reach the scraping ramp, they are taken from the water surface and remove from the water. The solid materials such as grit which cannot float in the water settle down at the bottom of the tank. The materials settled down at the bottom of the tank are carried to the vertical screw inlet container by horizontal screw and removed from the wastewater by the vertical screw.

After the wastes which settles down and floats are removed from the wastewater and passes through the outlet floodgate and leaves the system.

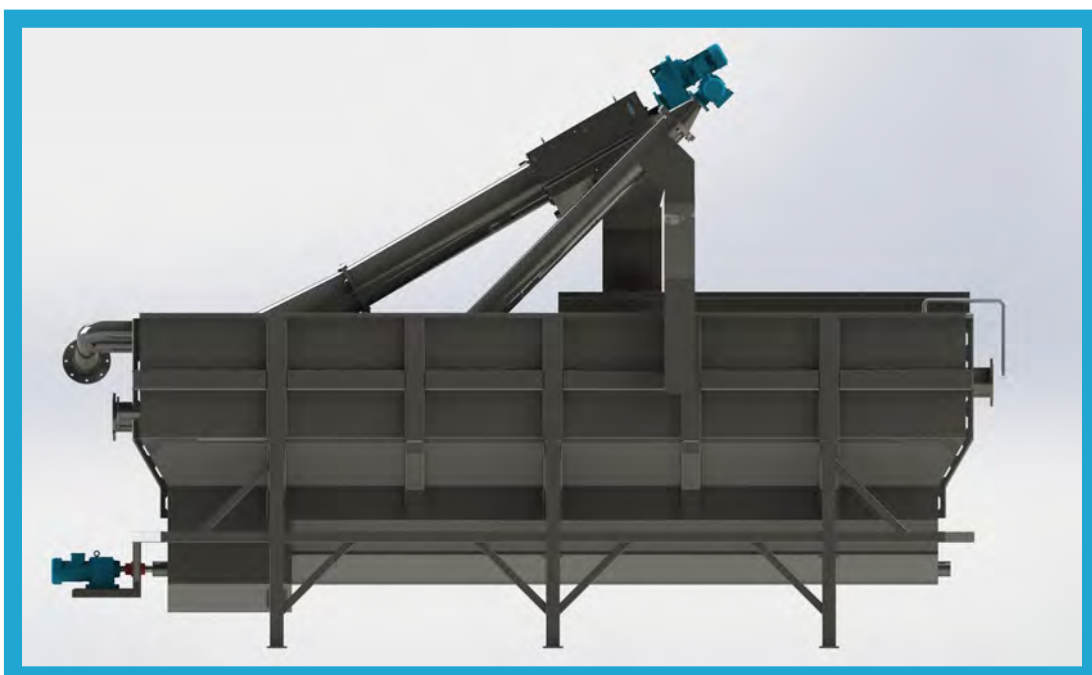

# Advantages

- Compact Design without Requiring Constructional Structures,
- Lower Space Requirement Compared to Classic Systems,
- Designing According to the Area That It Will Be Used,
- Low Operation and Maintenance Costs,
- Possibility to Control and Follow the System Operation over SCADA,
- Fully Automatic Operation,
- Low Energy Consumption,
- Manufactured From Corrosion Resistant Material,
- Lower Workmanship Requirement Thanks to Automatic Cleaning,
- Design Suitable for Outdoor Operation,
- Long Operation Life.

# Technical Specifications

- It is manufactured in any capacity and size.
- It is manufactured with covers. The upper covers provide additional safety in terms of occupational health and safety and allow control and maintenance.
- Since it is manufactured in completely closed form, the bad odors and the visual pollution are prevented.
- While the surface scrapers remove the pollutants such as oil and solid waste etc., the grit at the bottom is removed by the bottom screw and deep scrapers and then the angled screw.
- The inlet screen type may change depending on the sector. For this reason, it is manufactured to be used in many different sectors.

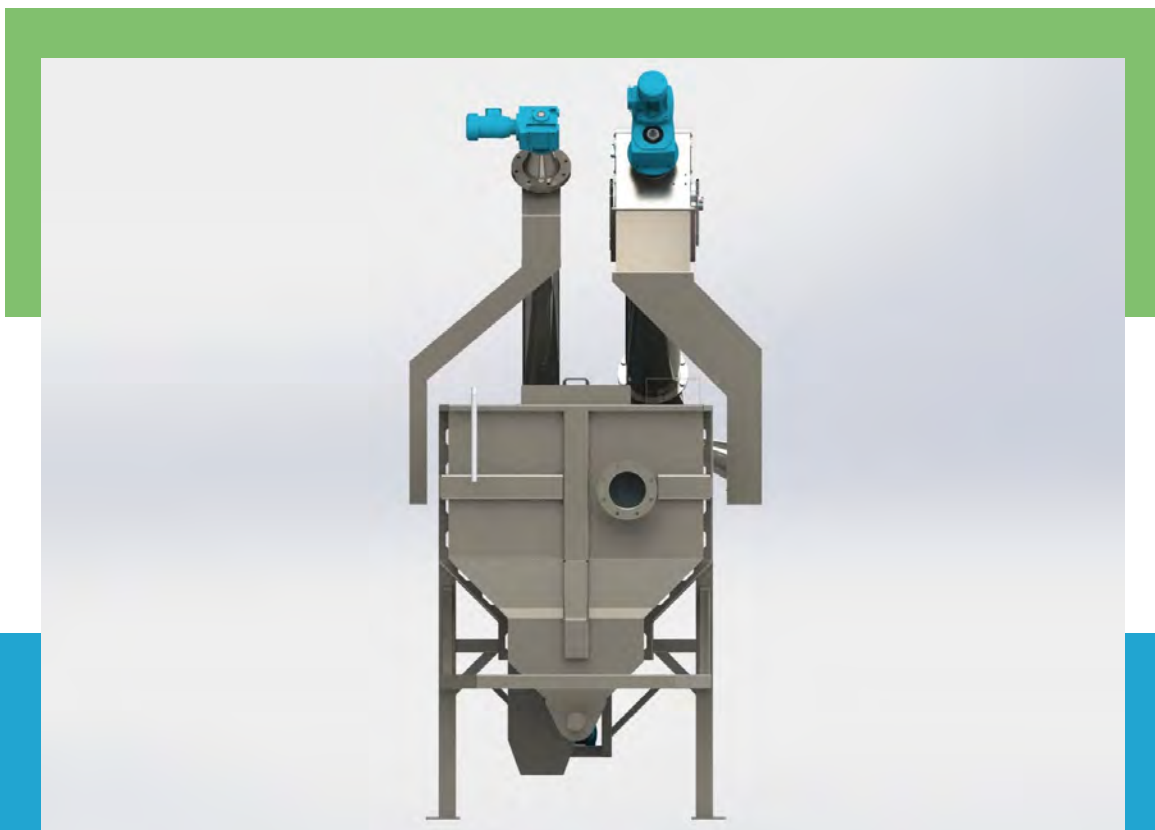



## Material Details

- Frame: They can be manufactured as DIN 1.4301 (AISI 304) or DIN 1.4401 (AISI 316).
- Screw: They can be manufactured as DIN 1.4301 (AISI 304), DIN 1.4401 (AISI 316) or S355J0 (St52).
- Wear Plate: They are manufactured as UPE 1000.

"Different materials can be preferred in accordance with the request of the customer."

## Accessories

- Upper Cover
- Tube Diffuser
- Oil Sheets
- Waste Container\*
- Blower\*
- Water Discharge Valve\*
- Emergency Button\*
- Local Power and Control Panel\*

\* Optional accessories are defined.

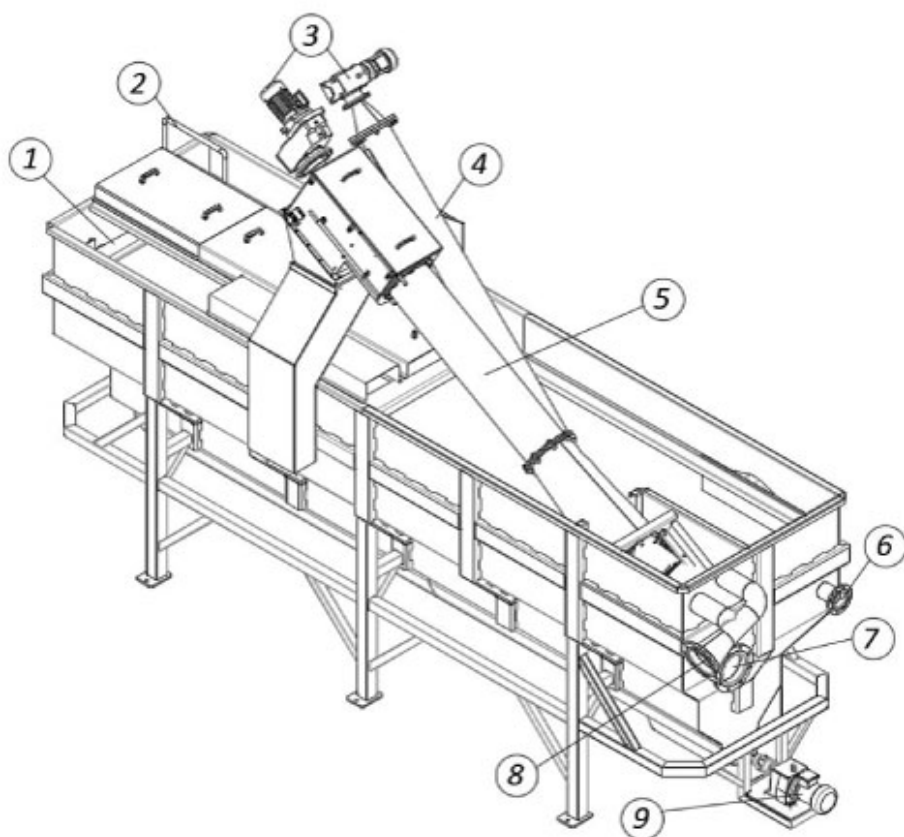

No	Part Name
1	Wastewater Outlet Weir
2	Air Inlet
3	Motor / Reducer
4	Grit Carriage Screw
5	Wastewater Inlet Solid Material Removal Screen
6	Oil - Grease Outlet
7	Wastewater Inlet
8	Gradual Overflow Line
9	Bottom Grit Carriage Screw Motor / Reducer



Marmaracık Mah. 1982. Sok. No: 13/1  
Ergene / Tekirdağ / TÜRKİYE  
+90 0282 686 63 33 pbx +90 0282 686 63 34

[www.baharmuhendislik.com](http://www.baharmuhendislik.com)